

15-17 Eastgate Street, Bury St. Edmunds, Suffolk, IP33 1XX
Tel: 01284 760770
bury@shiresestateagents.co.uk
www.shiresresidential.com

shires

Estate & Letting Agents



Raedwald Drive, Bury St Edmunds, Suffolk, IP32 7DA

Rent - £1,200 Deposit - £1,384

Modern semi-detached house located on the popular Moreton Hall development, convenient for all local amenities. This property has the benefit of a gas fired heating system, driveway parking and rear gardens.

- ENTRANCE HALLWAY
- NEWLY REFURBISHED KITCHEN
- THREE BEDROOMS
- REAR GARDEN
- AVAILABLE ASAP
- SITTING ROOM
- BATHROOM
- DRIVEWAY AND PARKING
- NEW GAS FIRED HEATING, EPC 72, C
- PLEASE FILL OUT AN ENQUIRY



Council Tax Band: C - EPC Rating: null

GROUND FLOOR
32.8 sq.m. (353 sq.ft.) approx.

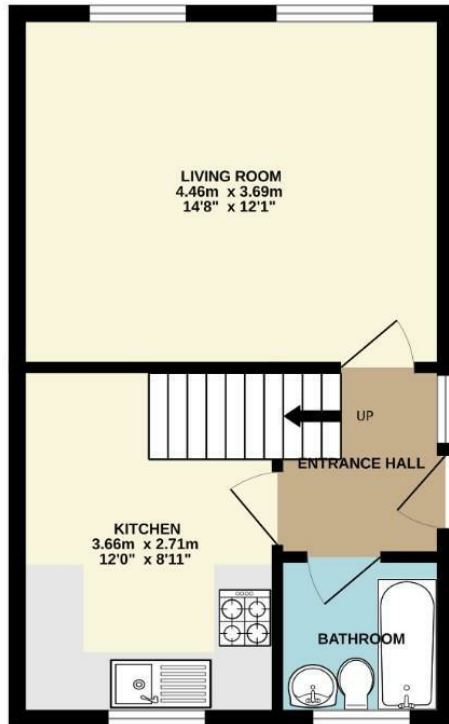

1ST FLOOR
32.8 sq.m. (353 sq.ft.) approx.

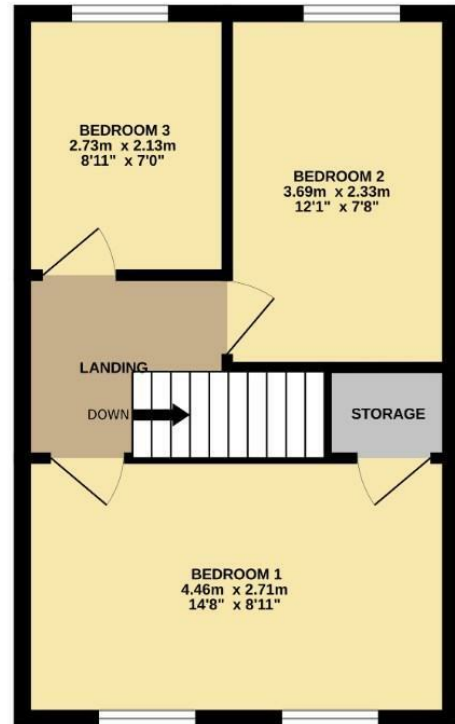

TOTAL FLOOR AREA : 65.5 sq.m. (705 sq.ft.) approx.

Whilst every attempt has been made to ensure the accuracy of the floorplan contained here, measurements of doors, windows, rooms and any other items are approximate and no responsibility is taken for any error, omission or mis-statement. This plan is for illustrative purposes only and should be used as such by any prospective purchaser. The services, systems and appliances shown have not been tested and no guarantee as to their operability or efficiency can be given.
Made with Metropix ©2025

